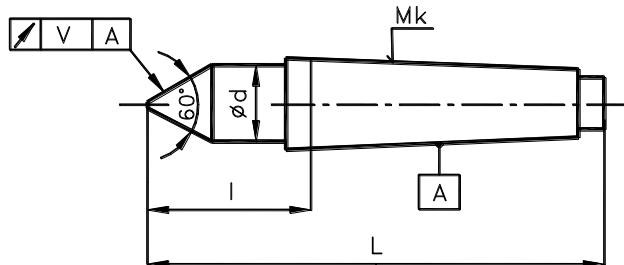

DEAD CENTRES
**ČSN ISO 298 (24 3310)
DIN 806**

The centres serve to clamp workpieces on machine tools or check instruments. The centres of Nk=0-5 sizes are all hardened to HRC 58-62 hardness. On centres of Mk=6 size the tip is hardened along the length 80 mm while the remaining part is heat treated. The centres are made of tool steel. MORSE taper shank, ČSN 220420 (DIN 228, ISO 296) without clamping thread.

| Mk | $\varnothing d$ | L | l | Q | G | V |
|----|-----------------|-----|------|-------|------|-------|
| 1 | 11 | 80 | 26.5 | 125 | 0.06 | 0.003 |
| 2 | 17 | 100 | 36 | 325 | 0.16 | |
| 3 | 23 | 125 | 44 | 650 | 0.40 | |
| 4 | 30 | 160 | 57.5 | 1 000 | 0.80 | |
| 5 | 42 | 200 | 70.5 | 2 500 | 1.80 | |
| 6 | 60 | 280 | 98 | 5 000 | 5.45 | |

Dimensions in mm.

Legend:

Mk.... MORSE taper

Q weight of workpiece [kg]

G weight of centre [kg]

V max. roundness deviation