

Pilana

METAL

Made in Czech Republic
since 1934



Standard products
Production to order (special sizes)
Customized colours and design
Private labels

Sabre Saw Blades Hand & Power Hacksaw Blades

Our mission

PILANA METAL is a Czech company with a long history of tool manufacturing. We have been producing cutting tools in our plant in Hulín since 1934. At that time our founders began manufacturing hand saws and circular saw blades for wood and in 1965 they also started producing tools for cutting metal.

Since that time, hand and machine hacksaw blades have been an integral part of our product range. The portfolio has been modernized and expanded over the years, up to the form you can see in today's catalogue. We now offer a much-expanded range of hacksaw blades whilst another division of our company is engaged in the production of bimetal band saw blades for cutting metals or hardwood.

All of our products exhibit exceptionally high quality. For our production we use only the best steel from European suppliers, and we benefit from decades of experience in its processing. We offer hacksaw blades, not only under our traditional brands, PILANA and MYROS, but for many customers we also supply private label tools.

We are proud of the really close working relationships we have built with all of our customers. Whether you're a big company or a relatively small one, we can adapt to your needs. We will always do our best to deliver the product exactly to your requirements. We have been working with many of our customers for successive decades, but we are still excited to welcome the demands and challenges of new clients from all over the world.

We look forward to our future business, to the next meeting with you and to the common satisfaction of a job well done!

Contents

3. Hand Hacksaw Blades MYROS SPECIAL
4. Sabre saw blades for Metal cutting - 0,9 mm
5. Sabre saw blades for Metal cutting - 1,3 mm
6. Sabre saw blades for wooden pallets recycling
7. Sabre saw blades with progressive teeth
8. 8% COBALT HSS BIMETAL Hand Hacksaw Blades
9. HSS BIMETAL Hand Hacksaw Blades
10. HSS BIMETAL Blades - special teeth
11. 3% COBALT HSS FLEXIBLE Hand Hacksaw Blades
12. HSS FLEXIBLE Hand Hacksaw Blades
13. 3% COBALT HSS ALL HARD Hand Hacksaw Blades
14. HSS ALL HARD Hand Hacksaw Blades
15. HCS FLEXIBLE Hand Hacksaw Blades
16. HSS TRIMETAL & HSS ALL HARD Double Sided
17. HCS Double Sided Hacksaw Blades (painted)
18. Details and pictures of each package option
19. Hacksaw frames – DIN 6473 type, 300 mm
20. Mini Hacksaw & Handy Hacksaw
21. Next options of Handy Hacksaw
22. KMITOS Machine saw blades
23. HSS Power hacksaw blades

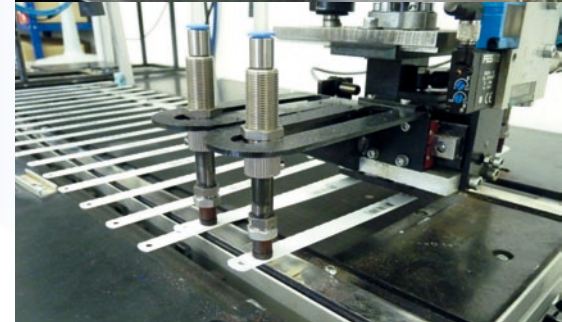

Hand Hacksaw Blades MYROS SPECIAL



The original brand MYROS SPECIAL covers the range of the unpainted blades that are manufactured according to the Czech state standards ČSN 222950 and ČSN 222951. The blades are induction hardened in oil, which is also a preservative. The blades have a simple design to ensure a low price, but its utility value is comparable with the value of painted HCS blades. The hardness of the teeth is 63-65 HRC.



Identification	Sizes	Order code	TPI	Packing: box	Packing weight
222950, one-sided	300 x 13 x 0,65 mm	R-3013-18-P	18 TPI	100 pcs	2000 g
222950, one-sided	300 x 13 x 0,65 mm	R-3013-24-P	24 TPI	100 pcs	2000 g
222950, one-sided	300 x 13 x 0,65 mm	R-3013-32-P	32 TPI	100 pcs	2000 g
222951, double-sided	300 x 20 x 0,65 mm	R-3020-18-P	18 TPI	100 pcs	3000 g
222951, double-sided	300 x 20 x 0,65 mm	R-3020-24-P	24 TPI	100 pcs	3000 g
222951, double-sided	300 x 20 x 0,65 mm	R-3020-32-P	32 TPI	100 pcs	3000 g
222951, double-sided	300 x 25 x 0,65 mm	R-3025-18-P	18 TPI	72 pcs	2660 g
222951, double-sided	300 x 25 x 0,65 mm	R-3025-24-P	24 TPI	72 pcs	2660 g



Usage	Sizes	Order code	TPI	Packing: box	Packing: weight
metal/plastic	300 x 20 x 0,65 mm	K-3020-24/14-P	24/14 TPI	100 pcs	3000 g
metal/wood	300 x 20 x 0,65 mm	K-3020-24/8-P	24/8 TPI	100 pcs	3000 g
metal/plastic	300 x 25 x 0,65 mm	K-3025-24/14-P	24/14 TPI	72 pcs	2660 g
metal/wood	300 x 25 x 0,65 mm	K-3025-24/8-P	24/8 TPI	72 pcs	2660 g

Sabre saw blades for Metal cutting - thickness 0,9 mm

Application and advantages of these blades:

HSS BiMetal blades with exceptional cutting performance and wear resistance, also suitable for stainless steels. Due to 8% cobalt alloy HSS wire welded to a flexible spring body the blades reach the longest lifespan. Universal shank 12,7 mm (1/2") for all common brands.

- 10/14 TPI - cutting of pipes, profiles, bars and sheet metals 5-9 mm thick.
- 14 TPI - cutting of pipes, profiles, bars and sheet metals 4-7 mm thick.
- 18 TPI - cutting of pipes, profiles and sheet metals 2-5 mm thick.
- 24 TPI - cutting of thin wall pipes and sheet metals 1,5 -3 mm thick.
- 32 TPI - cutting of thin wall pipes and sheet metals < 1,5 mm.

Mechanical attributes and design of the blades:

Type of blades: UNIVERSAL reciprocating saw blades - FORM S1
Size of the blades: 19 x 0,9 mm
Steel grade: 8% cobalt HSS BiMetal steel
Teeth hardness: 64-67 HRC
Body hardness: 50 +/- 2 HRC
Painting: white (RAL 9016)
Printing: blue

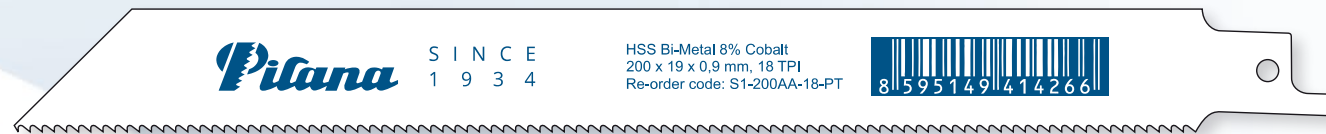

Order codes and packaging information:

The blades are packaged in transparent plastic tubes, 5 blades each, ready for shop display. Each blade printed with EAN code.

Lenght/TPI	10/14 TPI	14 TPI	18 TPI	24 TPI	32 TPI
150	S1-150AA-V1-PT	S1-150AA-14-PT	S1-150AA-18-PT	S1-150AA-24-PT	S1-150AA-32-PT
200	S1-200AA-V1-PT	S1-200AA-14-PT	S1-200AA-18-PT	S1-200AA-24-PT	S1-200AA-32-PT
225	S1-225AA-V1-PT	S1-225AA-14-PT	S1-225AA-18-PT	S1-225AA-24-PT	S1-225AA-32-PT
250	S1-250AA-V1-PT	S1-250AA-14-PT	S1-250AA-18-PT	S1-250AA-24-PT	
300			S1-300AA-18-PT	S1-300AA-24-PT	

Sabre saw blades for Metal cutting - thickness 1,3 mm



Application and advantages of these blades:

HSS BiMetal blades with exceptional cutting performance and wear resistance, also suitable for stainless steels. Due to the body thickness of 1,3 mm, the blades are ready for HEAVY usage.

5/7 - cutting of pipes, profiles, bars and sheet metals >10 mm thick.

8/11 - cutting of pipes, profiles, bars and sheet metals 6-10 mm thick.

10/14 TPI - cutting of pipes, profiles, bars and sheet metals 5-9 mm thick.

14 TPI - cutting of pipes, profiles, bars and sheet metals 4-7 mm thick.

18 TPI - cutting of pipes, profiles and sheet metals 2-5 mm thick.

Use cooling lubricants when cutting, increasing the lifespan by hundreds of percent.

Mechanical attributes and design of the blades:

Type of blades: HEAVY reciprocating saw blades - FORM S1

Size of the blades: 19 x 1,3 mm

Steel grade: 8% cobalt HSS BiMetal steel

Teeth hardness: 64-67 HRC

Body hardness: 50 +/- 2 HRC

Painting: white (RAL 9016)

Printing: blue

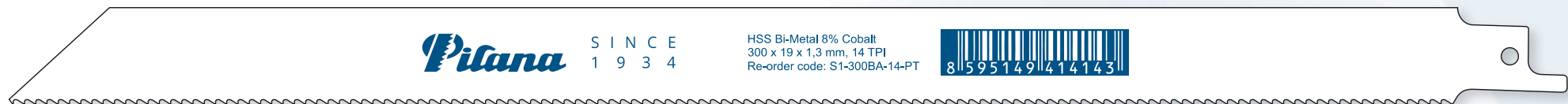

Order codes and packaging information:

The blades are packaged in transparent plastic tubes, 5 blades each, ready for shop display. Each blade printed with EAN code.

Lenght/TPI	5/7	8/11	10/14	14	18
150	S1-150BA-V4-PT	S1-150BA-V5-PT	S1-150BA-V1-PT	S1-150BA-14-PT	S1-150BA-18-PT
200	S1-200BA-V4-PT	S1-200BA-V5-PT	S1-200BA-V1-PT	S1-200BA-14-PT	S1-200BA-18-PT
225	S1-225BA-V4-PT	S1-225BA-V5-PT	S1-225BA-V1-PT	S1-225BA-14-PT	S1-225BA-18-PT
250	S1-250BA-V4-PT	S1-250BA-V5-PT	S1-250BA-V1-PT	S1-250BA-14-PT	S1-250BA-18-PT
300	S1-300BA-V4-PT	S1-300BA-V5-PT	S1-300BA-V1-PT	S1-300BA-14-PT	S1-300BA-18-PT

Sabre saw blades for wooden pallets recycling

Application and advantages of these blades:

Recycling of wooden pallets, nail-embedded wood and wood with other metal residues. HSS BiMetal blades with exceptional cutting performance, wear resistance and the longest lifespan. HSS wire welded to a spring body guarantees the greatest flexibility of the blades. Universal shank 12,7 mm (1/2") for all common brands. The FORM S2 avoids jamming of the blades in the material cut. All the TPIs enable cutting with high speed, safety and reduction of vibration.

Blades with the body 1,3 mm thick are prepared for HEAVY usage. The blades are also available without painting and printing (reducing costs for bulk consumers).

Mechanical attributes and design of the blades:

Type of blades: RECYCLING reciprocating saw blades - FORM S2
Size of the blades: 19 x 0,9 or 19 x 1,3 mm
Steel grade: 8% cobalt HSS BiMetal steel
Teeth hardness: 64-67 HRC
Body hardness: 50 +/- 2 HRC
Painting: white (RAL 9016)
Printing: blue

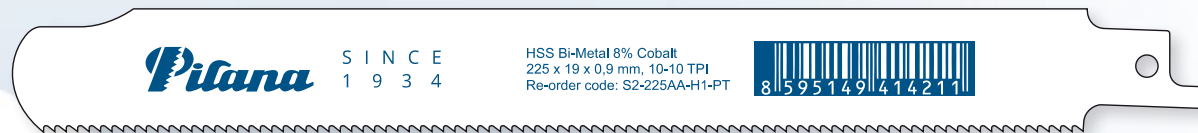

Order codes and packaging information:

The blades are packaged in transparent plastic tubes, 5 blades each, ready for shop display. Each blade printed with EAN code.

Lenght/TPI	thickness	10/10	10/14	8/12
200	0,9 mm	S2-200AA-H1-PT	S2-200AA-V1-PT	
225	0,9 mm	S2-225AA-H1-PT	S2-225AA-V1-PT	
250	0,9 mm	S2-250AA-H1-PT	S2-250AA-V1-PT	
225	1,3 mm			S2-225BA-V3-PT
250	1,3 mm			S2-250BA-V3-PT

Sabre saw blades with progressive teeth

Application and advantages of these blades:

HSS and HCS blades with exceptional cutting performance and lifespan for cutting wood, metal and plastic. Universal shank 12,7 mm (1/2") for all common brands. 8/13 TPI PROGRESSIVE - thanks to progressive teeth the blades reach fast cutting in all common materials such as steel, aluminium, plastics and wood. Suitable also for cutting different wall thicknesses. For cutting materials > 4 mm.

6/11 TPI PROGRESSIVE - fast and effective cutting of all common materials such as building steel, aluminium, plastics and wood. Also suitable for cutting combined materials with different strength and density. For cutting materials > 6 mm.

6/10 TPI PROGRESSIVE - very fast and clean cuts especially in wood, **made of HCS steel, cross ground teeth**. The blades are suitable for softwood, building timber and all non-abrasive wood-based materials used in construction.

Mechanical attributes and design of the blades:

- Type of blades:** reciprocating (sabre) saw blades - FORM 4
- Sizes of the blades:** width 19 mm, thickness 0,9 or 1,3 mm
- Teeth hardness:** 64-67 HRC
- Painting:** dark yellow
- Printing:** black
- Rec. speed for cutting wood:** 2000-2800 pulls in minute
- Rec. speed for cutting plastic:** about 500 pulls in minute



Order codes and packaging information:

The blade are packaged in transparent plastic tubes, 5 blades each, ready for shop display. Each blade printed with EAN code.

Size/TPI	TPI	Order Code
150 x 0,9 mm	8/13	S4-150AA-V7-PT
200 x 1,3 mm	6/11	S4-200BA-V6-PT
200 x 1,3 mm	6/10	S4-200HA-K1-PT

8% COBALT HSS BIMETAL Hand Hacksaw Blades



Application and advantages of these blades:

Suitable especially for **extra hard** steels up to 1200 N/mm², **stainless steel** and similar materials.

Bimetal high-speed steel, **shatterproof**, dual heat treatment to reduce shocks, effortless sawing, a very long-lasting blade.

The blades are intended for professional use by craftsmen.

Mechanical attributes and design of the blades:

Teeth hardness: 64-67 HRC

Body hardness: 50 +/-2 HRC

Teeth setting: wavy

Sizes: 300 x 13 x 0,63 mm (12 x ½ x 0,025")

Painting: black (RAL 9005)

Printing: white



Packaging and order codes:

There are four different standard packages of blades, as you can see below:

TPI	blue plastic box of 100 pcs	black plastic box of 50 pcs	plastic tube of 10 pcs	plastic tag of 2 pcs
14	BC-3013-14-P	BC-3013-14-PB	BC-3013-14-PT	BC-3013-14-PE
18	BC-3013-18-P	BC-3013-18-PB	BC-3013-18-PT	BC-3013-18-PE
24	BC-3013-24-P	BC-3013-24-PB	BC-3013-24-PT	BC-3013-24-PE
32	BC-3013-32-P	BC-3013-32-PB	BC-3013-32-PT	BC-3013-32-PE

HSS BIMETAL Hand Hacksaw Blades



Application and advantages of these blades:

Specially suited for **hard steel** up to 1100 N/mm² and similar materials. Bimetal high-speed steel, **shatterproof**, dual heat treatment to reduce shocks, **multipurpose**, smooth and effortless sawing, long-lasting blade. **The blades are intended also for professional use by craftsmen.**

Mechanical attributes and design of the blades:

Steel grade: DIN 1.3343 (M2)
Teeth hardness: 63-65 HRC
Body hardness: 50 +/-2 HRC
Teeth setting: wavy
Sizes: 300 x 13 x 0,63 mm (12 x 1/2 x 0,025")
Painting: white (RAL 9016)
Printing: blue



Packaging and order codes:

There are four different standard packages of blades, as you can see below:

TPI	blue plastic box of 100 pcs	black plastic box of 50 pcs	plastic tube of 10 pcs	plastic tag of 2 pcs
14	B-3013-14-P	B-3013-14-PB	B-3013-14-PT	B-3013-14-PE
18	B-3013-18-P	B-3013-18-PB	B-3013-18-PT	B-3013-18-PE
24	B-3013-24-P	B-3013-24-PB	B-3013-24-PT	B-3013-24-PE
32	B-3013-32-P	B-3013-32-PB	B-3013-32-PT	B-3013-32-PE

HSS BIMETAL Hand Hacksaw Blades – special teeth

Application and advantages of these blades:

VARIABLE TEETH suited specially for faster cutting. The blades cut with the same tooting technology as band saw blades for metal cutting (VARIO).

The blades are intended also for professional use by craftsmen.

Mechanical attributes and design of the blades:

Steel grade: DIN 1.3343 (M2)

Sizes: 300 x 13 x 0,63 mm (12 x ½ x 0,025")

Painting: white (RAL 9016)

Printing: black



Application and advantages of these blades:

PROGRESSIVE TEETH suited especially for easy start cutting and cutting profiles with different wall thicknesses.

The blades are intended also for professional use by craftsmen.

Mechanical attributes and design of the blades:

Steel grade: DIN 1.3343 (M2)

Sizes: 300 x 13 x 0,63 mm (12 x ½ x 0,025")

Painting: grey (RAL 7047)

Printing: red

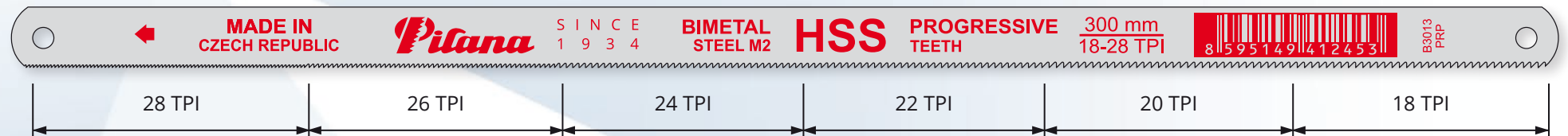

Packaging and order codes:

There are four different standard packages of blades, as you can see below:

TPI	blue plastic box of 100 pcs	black plastic box of 50 pcs	plastic tube of 10 pcs	plastic tag of 2 pcs
Variable	B-3013-VA-P	B-3013-VA-PB	B-3013-VA-PT	B-3013-VA-PE
Progressive	B-3013-PR-P	B-3013-PR-PB	B-3013-PR-PT	B-3013-PR-PE

3% COBALT HSS FLEXIBLE Hand Hacksaw Blades



The blades are made from cobalt HSS steel strip with a hardened teeth area. Heat treatment creates longitudinal areas with different hardnesses. The teeth that have a hardness of 63-65 HRC are followed by several areas with gradually decreasing hardness. Thanks to this heat treatment method, the blades offer outstanding flexibility.

Application and advantages of these blades:

Suitable especially for **extra hard** steels up to 900 N/mm², **stainless steel** and similar materials.

High speed steel, **flexibility combined with hardness**, unbreakable, high cobalt content, accurate, smooth and safe sawing, an extremely long-lasting blade.

The blades are intended for professional use by craftsmen.

Mechanical attributes and design of the blades:

Teeth hardness: 63-65 HRC

Teeth setting: wavy

Sizes: 300 x 13 x 0,60 mm (12 x ½ x 0,024")

Painting: blue-green

Printing: white



Packaging and order codes:

There are four different standard packages of blades, as you can see below:

TPI	black plastic box of 100 pcs	black plastic box of 50 pcs	plastic tube of 10 pcs	plastic tag of 2 pcs
18	FC-3013-18-P	FC-3013-18-PB	FC-3013-18-PT	FC-3013-18-PE
24	FC-3013-24-P	FC-3013-24-PB	FC-3013-24-PT	FC-3013-24-PE
32	FC-3013-32-P	FC-3013-32-PB	FC-3013-32-PT	FC-3013-32-PE

HSS FLEXIBLE Hand Hacksaw Blades

The blades are made from HSS steel strip with a hardened teeth area. Heat treatment creates longitudinal areas with different hardnesses. The teeth that have a hardness of 62-65 HRC are followed by several areas with gradually decreasing hardness. Thanks to this heat treatment method, the blades offer outstanding flexibility.

Application and advantages of these blades:

Suitable for cutting various materials up to steel hardness 700 N/mm².

High speed steel, **flexibility**, unbreakability, accurate, smooth and safe sawing, a very long-lasting blade.

Mechanical attributes and design of the blades:

Steel grade: DIN 1.3333 (ABC III)

Teeth hardness: 62-65 HRC

Teeth setting: wavy

Sizes: 300 x 13 x 0,60 mm (12 x ½ x 0,024")

Painting: red (RAL 3020)

Printing: white



Packaging and order codes:

There are four different standard packages of blades, as you can see below:

TPI	black plastic box of 100 pcs	black plastic box of 50 pcs	plastic tube of 10 pcs	plastic tag of 2 pcs
18	F-3013-18-P	F-3013-18-PB	F-3013-18-PT	F-3013-18-PE
24	F-3013-24-P	F-3013-24-PB	F-3013-24-PT	F-3013-24-PE
32	F-3013-32-P	F-3013-32-PB	F-3013-32-PT	F-3013-32-PE

3% COBALT HSS ALL HARD Hand Hacksaw Blades



The HSS ALL HARD blades are made from cobalt HSS steel strip hardened at full cross-section. High hardness of the blades, consistent throughout the whole area, gives the blades extreme rigidity and strength. **The blades are mainly suitable for firmly clamped material.** The annealed ends of the blades prevent the formation of cracks in the clamping holes during cutting.

Application and advantages of these blades:

Suitable especially for **extra hard** steels up to 900 N/mm², **stainless steel** and similar materials.

High speed steel, **NON-FLEXIBLE**, high hardness due to the high cobalt content, accurate, smooth and safe sawing, a very long-lasting blade.

The blades are intended for professional use by craftsmen.

Mechanical attributes and design of the blades:

Teeth hardness: 63-65 HRC

Teeth setting: wavy

Sizes: 300 x 13 x 0,60 mm (12 x ½ x 0,024")

Painting: blue (RAL 5024)

Printing: black



Packaging and order codes:

There are four different standard packages of blades, as you can see below:

TPI	black plastic box of 100 pcs	black plastic box of 50 pcs	plastic tube of 10 pcs	plastic tag of 2 pcs
18	AC-3013-18-P	AC-3013-18-PB	AC-3013-18-PT	AC-3013-18-PE
24	AC-3013-24-P	AC-3013-24-PB	AC-3013-24-PT	AC-3013-24-PE
32	AC-3013-32-P	AC-3013-32-PB	AC-3013-32-PT	AC-3013-32-PE

HSS ALL HARD Hand Hacksaw Blades



The HSS ALL HARD blades are made from HSS steel strip hardened at full cross-section. High hardness of the blades, consistent throughout the whole area, gives the blades extreme rigidity and strength. **The blades are mainly suitable for firmly clamped material.** The annealed ends of the blades prevent the formation of cracks in the clamping holes during cutting.

Application and advantages of these blades:

Suitable for cutting various materials up to steel hardness 700 N/mm².

High speed steel, **NON-FLEXIBLE**, accurate, smooth and safe sawing, a very long-lasting blade.

Mechanical attributes and design of the blades:

Steel grade: DIN 1.3333 (ABC III)

Teeth hardness: 63-65 HRC

Teeth setting: wavy

Sizes: 300 x 13 x 0,60 mm (12 x ½ x 0,024")

Painting: blue (RAL 5002)

Printing: white



Packaging and order codes:

There are four different standard packages of blades, as you can see below:

TPI	black plastic box of 100 pcs	black plastic box of 50 pcs	plastic tube of 10 pcs	plastic tag of 2 pcs
18	A-3013-18-P	A-3013-18-PB	A-3013-18-PT	A-3013-18-PE
24	A-3013-24-P	A-3013-24-PB	A-3013-24-PT	A-3013-24-PE
32	A-3013-32-P	A-3013-32-PB	A-3013-32-PT	A-3013-32-PE

HCS FLEXIBLE Hand Hacksaw Blades

HCS hand hacksaw blades are made from high carbon steel which undergoes induction hardening heat treatment. The high carbon content allows us to produce blades with the same hardness as HSS steel blades. These blades are not designed for particularly challenging projects, but they are well-suited for Do-it-yourself use. Our factory only uses steel strips manufactured in the Czech Republic, guaranteeing levels of quality in excess of those products from alternative markets.

Application and advantages of these blades:

Suitable for DIY cutting of various materials such as steel, aluminium and other non-ferrous metals, plastic.

FLEXIBLE, smooth, effortless and safe sawing.

Mechanical attributes and design of the blades:

Teeth hardness: 63-65 HRC

Teeth setting: wavy

Sizes: 300 x 13 x 0,65 mm (12 x ½ x 0,025")

Painting: orange (RAL 2008)

Printing: black



Packaging and order codes:

There are four different standard packages of blades, as you can see below:

TPI	orange plastic box of 100 pcs	black plastic box of 50 pcs	plastic tube of 10 pcs	plastic tag of 2 pcs
18	C-3013-18-P	C-3013-18-PB	C-3013-18-PT	C-3013-18-PE
24	C-3013-24-P	C-3013-24-PB	C-3013-24-PT	C-3013-24-PE
32	C-3013-32-P	C-3013-32-PB	C-3013-32-PT	C-3013-32-PE

HSS TRIMETAL & HSS ALL HARD Double Sided Hand Hacksaw Blades

HSS TRIMETAL blades are produced from a steel strip its body is made from spring steel and welded to it are two HSS wires – one to each side. Hence the name, trimetal. The blades have the same qualities and the same **flexibility** as HSS BIMETAL blades.

HSS ALL HARD blades are made from HSS steel strip hardened at full cross-section and are therefore NOT flexible.

Mechanical attributes and design of the blades:

HSS TRIMETAL FLEXIBLE

Steel grade: DIN 1.3343 (M2)

Sizes: 300 x 25 x 0,63 mm (12 x 1 x 0,025")

Painting: grey (RAL 7047)

Printing: blue

HSS ALL HARD

Steel grade: DIN 1.3333 (ABC III)

Sizes: 300 x 25 x 0,65 mm (12 x 1 x 0,025")

Painting: blue (RAL 5002)

Printing: white



Packaging and order codes:

There are two different standard packages of blades, as you can see below:

TPI	type of blades	white plastic box of 50 pcs	plastic tag of 2 pcs
18	HSS TRIMETAL flexible	T-3025-18-PB	T-3025-18-PE
24	HSS TRIMETAL flexible	T-3025-24-PB	T-3025-24-PE
18	HSS all hard	A-3025-18-PB	A-3025-18-PE
24	HSS all hard	A-3025-24-PB	A-3025-24-PE

HCS Double Sided Hand Hackaw Blades (painted)

Painted HCS hand hacksaw blades are manufactured with standard and combi (combined) teeth numbers.

Application and advantages of these blades:

Suitable for DIY cutting of various materials like steel, aluminium and other non-ferrous metals, plastic.
FLEXIBLE, smooth, effortless and safe sawing.

Mechanical attributes and design of the blades:

Teeth hardness: 63-65 HRC
Teeth setting: wavy
Sizes: 300 x 20 or 25 x 0,65 mm (12 x 3/4 or 1 x 0,025")
Painting: 24 TPI – orange (RAL 2008); Combi TPI – grey (RAL 7047)
Printing: black

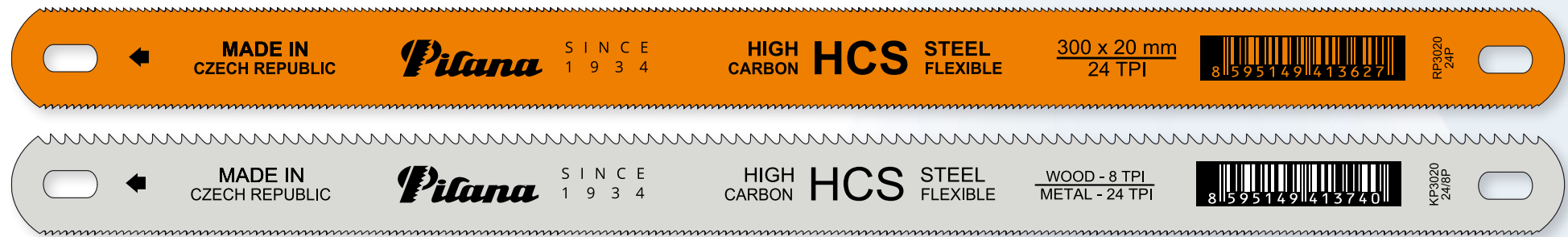

Packaging and order codes:

There are three different standard packages of blades, as you can see below:

TPI	width	black plastic box of 50 pcs	plastic tube of 10 pcs	plastic tag of 2 pcs
24	20 mm	RP-3020-24-PB	RP-3020-24-PT	RP-3020-24-PE
24	25 mm	RP-3025-24-PB	RP-3025-24-PT	RP-3025-24-PE
24/14	20 mm	KP-3020-24/14-PB	KP-3020-24/14-PT	KP-3020-24/14-PE
24/14	25 mm	KP-3025-24/14-PB	KP-3025-24/14-PT	KP-3025-24/14-PE
24/8	20 mm	KP-3020-24/8-PB	KP-3020-24/8-PT	KP-3020-24/8-PE
24/8	25 mm	KP-3025-24/8-PB	KP-3025-24/8-PT	KP-3025-24/8-PE

Details and pictures of each package option

Box of 100 blades



Box of 50 blades

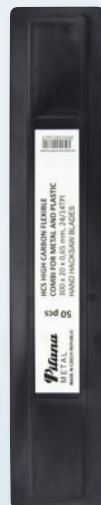

Transparent tube of 10 blades



Plastic tag of 2 blades



Plastic tag (double sided)



	weight (kg)	dimensions (mm)	overcarton	overcarton weight (kg)	overcarton dimensions (mm)
box of 100 blades	1,9	322 x 93 x 18	10 boxes	18,9	337 x 205 x 107
box of 50 blades (13mm)	0,95	320 x 47 x 17	20 boxes	19	337 x 205 x 107
box of 50 blades (20mm)	1,6	325 x 62 x 32	9 boxes	14,5	335 x 207 x 117
box of 50 blades (25mm)	1,85	325 x 62 x 32	9 boxes	16,7	335 x 207 x 117
transparent tube of 10 blades (13mm)	0,2	347 x 25 x 15	28 tubes	5,5	370 x 155 x 82
transparent tube of 10 blades (20mm)	0,3	347 x 25 x 15	28 tubes	8,7	370 x 155 x 82
transparent tube of 10 blades (25mm)	0,35	347 x 31 x 18	18 tubes	6,6	370 x 155 x 82
plastic tag of 2 blades (13mm)	0,04	345 x 50 x 3	50 tags	2,2	370 x 155 x 82
plastic tag of 2 blades (20mm)	0,07	345 x 52 x 4	50 tags	3,4	360 x 178 x 72
plastic tag of 2 blades (25mm)	0,08	345 x 65 x 4	50 tags	3,9	360 x 178 x 72

Hacksaw frames – DIN 6473 type, 300 mm

Heavy duty hacksaw frames made of flat steel bar size 18 x 8 mm with a wooden handle.

Advantages:

Heavy cross bolts on both sides are welded to the steel body.

The blade is fixed by two clasps that can not be lost.

Marking of the blades is undertaken by stamping (including private labels).

A variety of colours are used for painting the frames (powder coating).

Weight of frames: 0,73 kg/pc

Packing: 5 frames into a cardboard overcarton

Weight of the overcarton: 4,7 kg

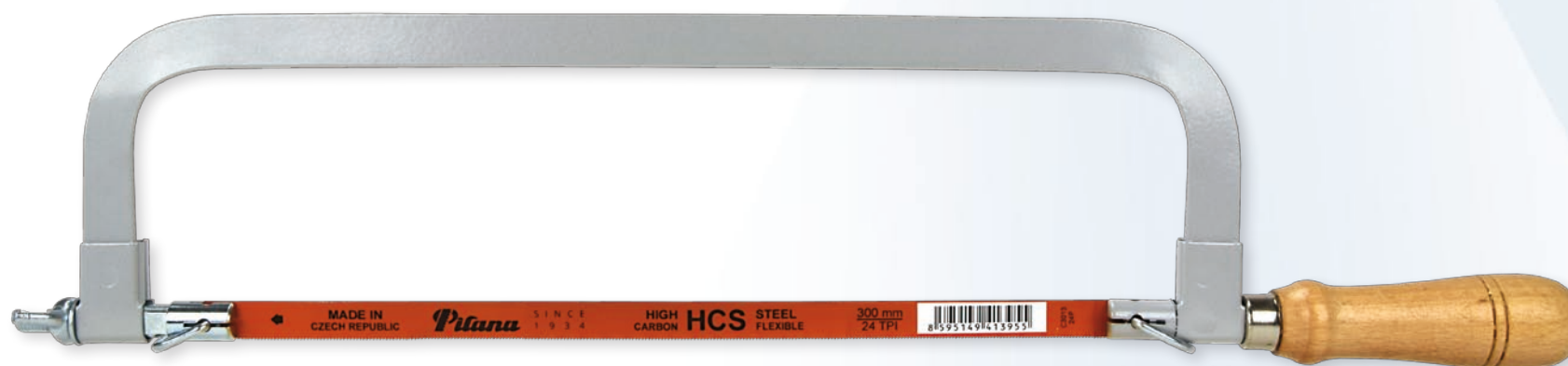

FRAME TYPE	ORDER CODE
Hacksaw frame without blade	HF-01
Hacksaw frame with HCS blade	HFB-01
Hacksaw frame with HSS BIMETAL blade	HFB-02

Mini Hacksaw & Handy Hacksaw



Mini Hacksaw

Our Mini Hacksaw is designed for easier cutting in hard-to-reach places. The ergonomic grip assures comfortable and safe cutting. The blade is made of bi-metal steel in order to ensure its flexibility and solidity. The blade is fixed by a metal screw and pad.

- Grip length:** 200 mm
- Total length:** 320 mm
- Specification of blade:** 300 x 13 x 0,65 mm, 24 TPI, Bi-Metal
- Order code:** MP-01
- Weight:** 76 g
- Packing:** 10 pcs



Handy Hacksaw

The Handy hacksaw is a tool suitable for smaller cutting operations. Its great advantage, when compared with a classic frame for metal cutting, is the possibility to hold the handy hacksaw in one hand and the cut material in the other (free) hand. The advantage over the minihacksaw is that the handy hacksaw is intended not only for cutting small parts. The hacksaw blade is not limited by the upper part of the handle and thanks to this, cutting components with a diameter up to ca 120 mm is possible. Combined toothing enables cutting of a broad range of material, from wood to plastic and steel. The inserted hacksaw blades differ from common ones by having a third clamping hole and are available as a separate item.

- The length of the handle:** 110 mm
- The length including the blade:** 315 mm
- The data for hacksaw blade:** 300 x 25 x 0,75 mm, kombi 24/14 TPI
- Order code:** HH-01
- Weight:** 87 g
- Packing:** 10 pcs

Next options of Handy Hacksaw



Handy Hacksaw with a spare blade

Practical packaging including a spare part.

Order code: HH-02

Weight: 125 g

Packing: 10 pcs



Handy Hacksaw w/o tag

Handy Hacksaw without paper tag, packed in a shrink foil.

Low cost design suitable for discounted sales in big department stores and DIY projects.

Order code: HH-w/o

Weight: 66 g

Packing: 30 pcs



Spare blades for Handy Hacksaw

Two spare blades packed on a plastic tag.

Order code: HHS2-P

Weight: 87 g

Packing: 50 pcs

KMITOS machine saw blades

Application and advantages of these blades:

HSS BiMetal or HSS all hard blades for using in all the hydraulic, pneumatic and electric compass saw machines. Universal shank with fixing holes 2/8,5 + 1/4,5 mm. For FEIN, SPITZNAS, PREMAG, ROCKWELL etc. Special dimensions and design of the blades according to the customer's requirements.

Mechanical attributes and design of the blades:

Type of blades: width 27 and 28 mm, thickness 1,6 or 2,0 mm
Steel grade: M2 for HSS all hard options and Matrix II for HSS Bi-Metal ones
Teeth hardness: 64-67 HRC
Teeth setting: raker
Painting: grey

Recommendations for higher lifespan:

Use a suitable cooling during the cutting process.
 Never start cutting on a material corner (edge).



Sizes (mm)	TPI	TPI	Weight (kg)
180 x 27 x 1,6	14	16	0,07
200 x 27 x 1,6	14	16	0,08
300 x 27 x 1,6	14	16	0,09
400 x 27 x 1,6	14	16	0,12
500 x 27 x 1,6	14	16	0,17
600 x 27 x 1,6	14	16	0,22
500 x 28 x 2,0	14	16	0,18
600 x 28 x 2,0	14	16	0,23
700 x 28 x 2,0	14	16	0,36

Marked items are delivered ex stock (produced of HSS BiM).

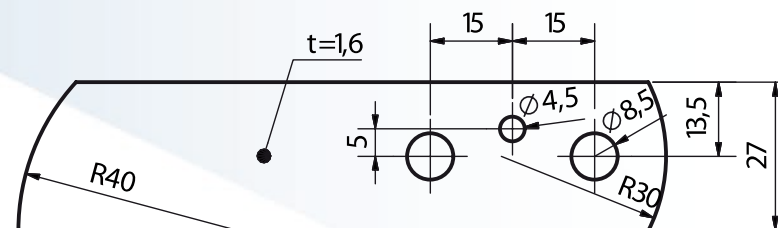

HSS Power hacksaw blades

Application and advantages of these blades:

HSS bi-metal and HSS all hard blades for using in all power hacksaw machines. Special dimensions and design of blades according to the customer's requirements.

Recommendations for higher lifespan of the blades:

- Use a suitable cooling during the cutting process.
- Never start cutting on a material corner (edge).
- Choose the right TPI for every size of cut material.
- 14 TPI - for cutting cross-section 3-8 mm
- 10 TPI - for cutting cross-section 8-15 mm
- 8 TPI - for cutting cross-section 12-20 mm
- 6 TPI - for cutting cross-section 20-50 mm
- 4 TPI - for cutting cross-section 40-150 mm

Mechanical attributes and design of the blades:

The HSS bi-metal blades are made of steel grade M2/D6A

The HSS all hard blades are made of steel metal sheet, grade ABC3

Tooth geometry: standard, rake angle 0°

Teeth hardness: 64-66 HRC, raker setting



HSS bi-metal power hacksaw blades - blue painted

Sizes (mm)	TPI	TPI	TPI	TPI	TPI	Weight (kg)
300 x 25 x 1,2		6	8	10	14	0,094
350 x 32 x 1,6	4	6	8	10	14	0,144
400 x 32 x 1,6	4	6	8	10	14	0,159
450 x 32 x 1,6	4	6	8	10	14	0,173
400 x 40 x 2,0	4	6	8	10		0,253
450 x 40 x 2,0	4	6	8	10		0,275
500 x 40 x 2,0	4	6	8	10		0,308

HSS all hard power hacksaw blades - grey painted

Sizes (mm)	TPI	TPI	TPI	TPI	Weight (kg)
550 x 50 x 2,5	4	6	8	10	0,542
600 x 50 x 2,0		6	8	10	0,471
600 x 50 x 2,5	4	6	8	10	0,574
650 x 50 x 2,5	4	6	8	10	0,600
700 x 50 x 2,5	4	6	8	10	0,650

Custom marking



EUROPEAN UNION
European Regional Development Fund
Operational Programme Enterprise
and Innovations for Competitiveness

As part of our efforts to support our customers, we also manufacture tools with client's logos. In addition to highlighting our brand PILANA and MYROS SPECIAL logos and graphics, we denote tools of our customers with their own brands and logos. We produce tools for well-known department stores and acclaimed tool producers. The production with custom marking makes up the majority of our production and includes hundreds of different markings.

We are ready to make a brand not just for big companies, but also for small traders and distributors, who purchase our tools in small quantities. Our care lies not only in the preparation of graphic designs and notation of the tools, but also in the supply of branded labels, packing and pallets. We are ready to help you pick the right colour, marking and packaging for tools featuring your own brand.

Do not hesitate to contact us. We will do our best to meet your needs!

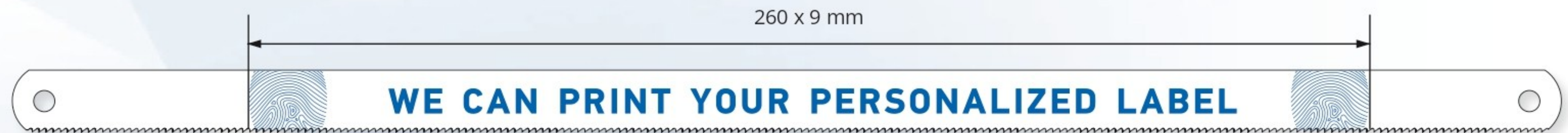

Pro Export Plus

V korytech 3234/18a
100 00 Praha 10
Czech Republic
proexport@proexport.cz